

4542 L B Mcleod Rd #A1
Orlando, FL 32811

FOR SUBLEASE
Office/Warehouse



Move In Ready Office + Industrial Space in West Park X

- 13,275 SF Available
- 22' Clear Height
- Excellent access to John Young Parkway, Kirkman Road, Interstate 4, and Florida's Turnpike.
- 7 minutes to the I-4/Florida Turnpike interchange.
- Minutes from Downtown Orlando, Universal Orlando Resort and theme parks, Orlando Outlet Marketplace, and much more!

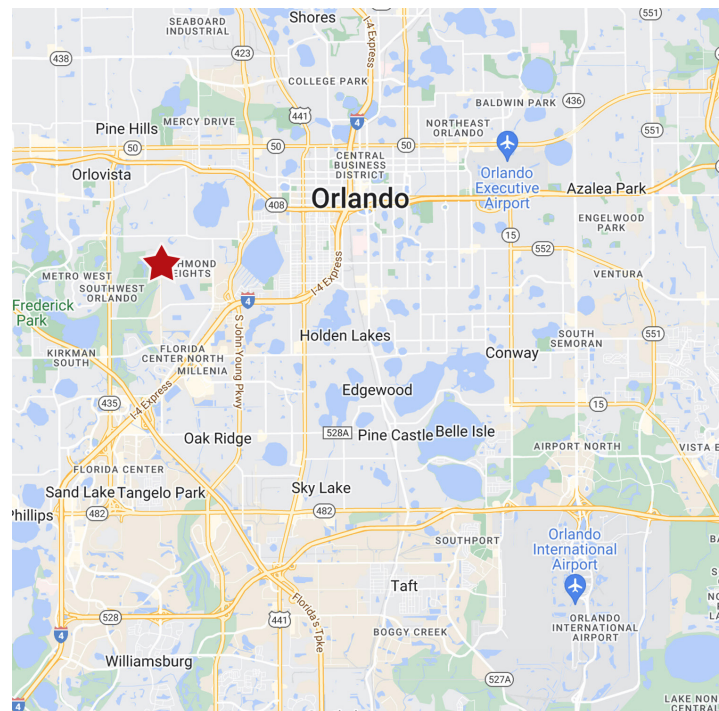

Brian Smith, SIOR, CCIM, MBA • 704.910.9518
brian@regentcre.com • www.regentcre.com

4542 L B Mcleod Rd #A1
Orlando, FL 32811

FOR SUBLEASE

Office/Warehouse

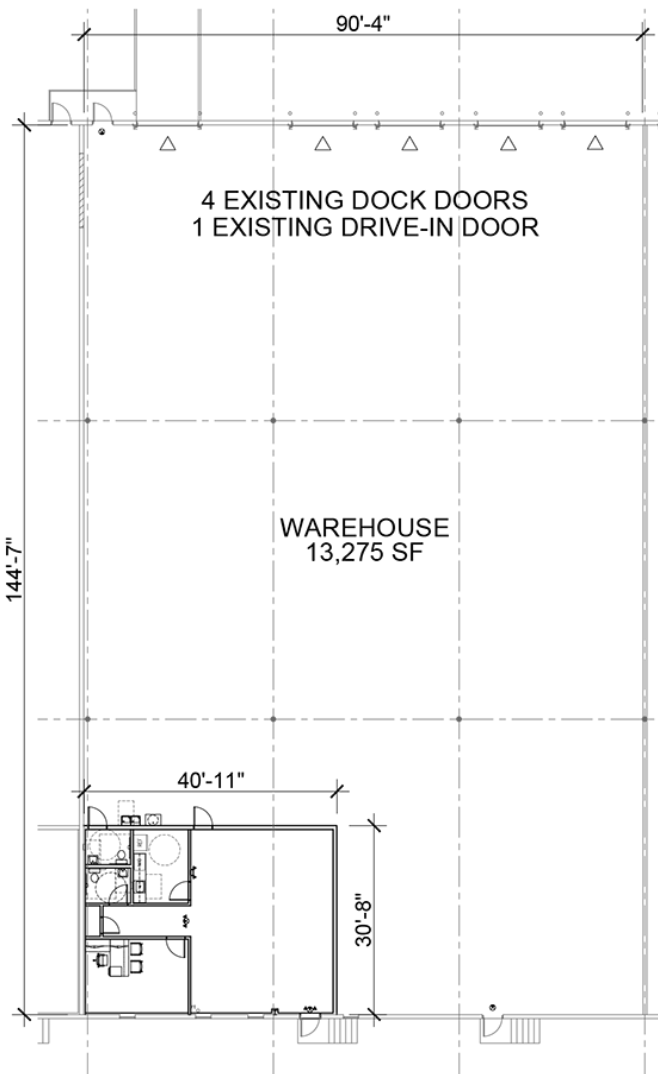

11,990 SF Warehouse

1,285 SF Office

13,275 SF Total



Brian Smith, SIOR, CCIM, MBA • 704.910.9518
brian@regentcre.com • www.regentcre.com